

ADDENDUM ACKNOWLEDGMENT

ADDENDUM NO. 2
Bid Due Date: 7/20/23

Dated: 7/17/23

NOTICE

It is the sole responsibility of the bidder to ensure that it has received any and all Addenda and the Philadelphia Redevelopment Authority may in their sole discretion reject any bid for which all Addenda have not been executed and returned.

RFP FOR

Description: Richmond Library Roof Systems Replacement

IS AMENDED AS FOLLOWS:

1. Addenda will be posted in the Richmond Roof RFP at <https://phdcpila.org/rfps-rfqs-sales/construction-rfps/> Each Bidder shall ascertain prior to submitting a proposal that Bidder has received all Amendments issued, and shall acknowledge their receipt in their proposal submission.
2. Find Architect's answers to Bidder's questions attached.
3. Remove Section 00 43 22 UNIT PRICES FORM and Replace with attached Section 00 43 22 UNIT PRICES FORM - ADDENDUM 2.

Bidder must acknowledge receipt of Addenda in their proposal submission.

Bidder Signature / Date

Richmond Library Roof RFP (Re-Bid)

Questions/RFIs:

1. Much of the brick pointing appears to be in good shape. Although we understand you'd like to repoint everything we suggest making another line item for brick pointing in the event that the other costs put the project over current budget/ just another option to be able to move forward.

A: Please see Addendum #1.

2. The current Ludowici roof appears to be an old clay red blend. Typically the only way to get the color appearance that is up there is to use a clay red blend which is just firing regular clay without color added. Are we to price the tile in color: 1.) Ludowici basic clay red 2.) Ludowici standard available matte colors or 3.) Ludowici custom colors? Current specification has colors in each category and want to confirm.

A: Confirmed as indicated in specification.

3. The current Ludowici roof has a vented ridge (type II) roughly every 5 ft on center. Are we to match this vented tile in kind and installation? It is called out in the specification but just confirming.

A: Confirmed as indicated in specification.

4. The current Ludowici roof has a one piece top coarse closure tile (not the common 'top fixture'). Are we to match this tile in kind and installation?

A: Yes, the top coarse closure tile is to match in kind and installation.

5. The specification calls for beveled eave tile. We were not able to see the eave from the ground today so just confirming that is the starter tile you'd like to use.

A: Confirmed as indicated in specifications.

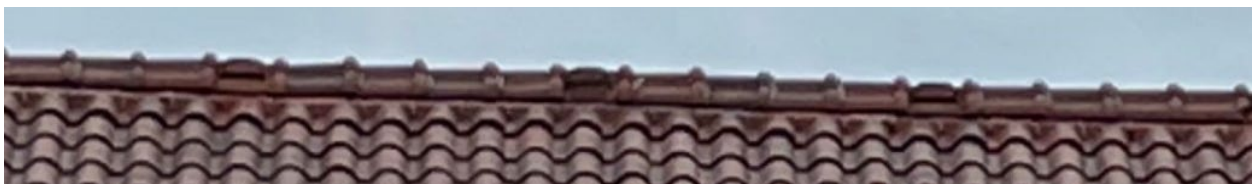

**SECTION 00 43 22
UNIT PRICES FORM**

PARTICULARS

- 1.01 The following is the list of Unit Prices referenced in the bid submitted by:
- 1.02 (Bidder) _____
- 1.03 TO (Owner): [_____]
- 1.04 dated _____ and which is an integral part of the Bid Form.
- 1.05 THE FOLLOWING ARE UNIT PRICES FOR SPECIFIC PORTIONS OF THE WORK AS LISTED AND ARE APPLICABLE TO AUTHORIZED VARIATIONS FROM THE CONTRACT DOCUMENTS.

UNIT PRICE LIST

- 2.01 Unit-Price No. 1: Brick re-pointing.
_____ dollars (\$) _____) per SF.
- 2.02 Unit-Price No. 2: Masonry stone re-pointing.
_____ dollars (\$) _____) per LF.
- 2.03 Unit-Price No. 3: 3/4" wood roof decking replacement.
_____ dollars (\$) _____) per SF.

END OF SECTION 00 43 22

This page intentionally left blank