

CONTRACTOR GENERAL NOTES:

1. VERIFY EXISTING CONDITIONS, FIELD DIMENSIONS, AND REPORT DISCREPANCIES IN THE DRAWINGS. DO NOT SCALE DRAWINGS.
2. PROVIDE & ENSURE ALL SAFETY PRECAUTIONS FOR CONTRACTORS, SUBCONTRACTORS, CITY EMPLOYEES, AND HEALTH CENTER PATIENTS.
3. PROVIDE TEMPORARY BARRIERS AND SEAL ALL WORK AREA OPENINGS FROM REST OF FACILITY, AND OPERATE HEPA-TYPE AIR CLEANERS DURING CONSTRUCTION.
4. PERFORM LOUD WORK WHEN THE CENTER IS CLOSED TO THE PUBLIC OR DURING THE DAY AS DIRECTED BY THE HEALTH CENTER.
5. KEEP THE PREMISES FREE DAILY FROM ACCUMULATION OF WASTE MATERIALS OR RUBBISH CAUSED BY CONTRACTOR OPERATIONS.
6. COORDINATE THE WORK BETWEEN ALL SUBCONTRACTORS IN THE PROPER INSTALLATION AND COMPLETION OF THEIR RESPONSIBILITIES OF THE PROJECT.
7. REPAIR ALL STRUCTURES AND SURFACES WHICH RESULT FROM DAMAGE CAUSED FROM THE CONTRACTOR'S WORK AT NO COST TO THE CITY OF PHILADELPHIA AND SHALL BE REPAIRED OR RESTORED TO THEIR ORIGINAL OR BETTER CONDITION.
8. TAKE ALL NECESSARY PRECAUTIONS TO PROTECT EXISTING UTILITIES AND MAINTAIN UNINTERRUPTED SERVICE.

DEMO/FLOOR PLAN KEY:

- FIXTURE TO BE REMOVED
- ▨ AREA OF PARTITION FOR SELECTIVE DEMOLITION
- ▨ NEW PARTITION

SELECTIVE DEMOLITION/SURFACE PREPARATION NOTES:

1. PROTECT ALL DOORS, RADIATORS AND COVERS, WINDOWS, CORRIDOR FLOOR, AND ANY SURFACE TO REMAIN IN WORK AREA.
2. WALLPAPER AREAS WHERE PEELING, REMOVE AND PATCH FOR 1/4" LAMINATE GWB.
3. REMOVE SINKS. PATCH SURROUNDING AREAS.
4. PREPARE PLUMBING CONNECTIONS FOR NEW COUNTER MOUNTED SINKS.
5. REMOVE, STORE, AND RE-INSTALL WALL PLATES FOR SWITCHES, OUTLETS, THERMOSTATS.
6. REMOVE: WALL BASE, WOOD CHAIR RAILS, WOOD SHELVES, ROOM 113 CASEWORK, AND PATCH SURROUNDING AREAS FOR NEW FINISHES.
7. REMOVE SURFACE MOUNTED POWER/DATA CONDUIT FOR RELOCATION.
8. PREPARE SUB-FLOOR FOR NEW TILE AFTER EXISTING FLOOR TILES ABATED BY OWNER, EXCEPT WHERE OTHERWISE NOTED.
9. REMOVE CLERESTORY FRAMING, PANELS, AND BLINDS, SEE A.2.

1 DEMO PLAN
1/8" = 1'-0"

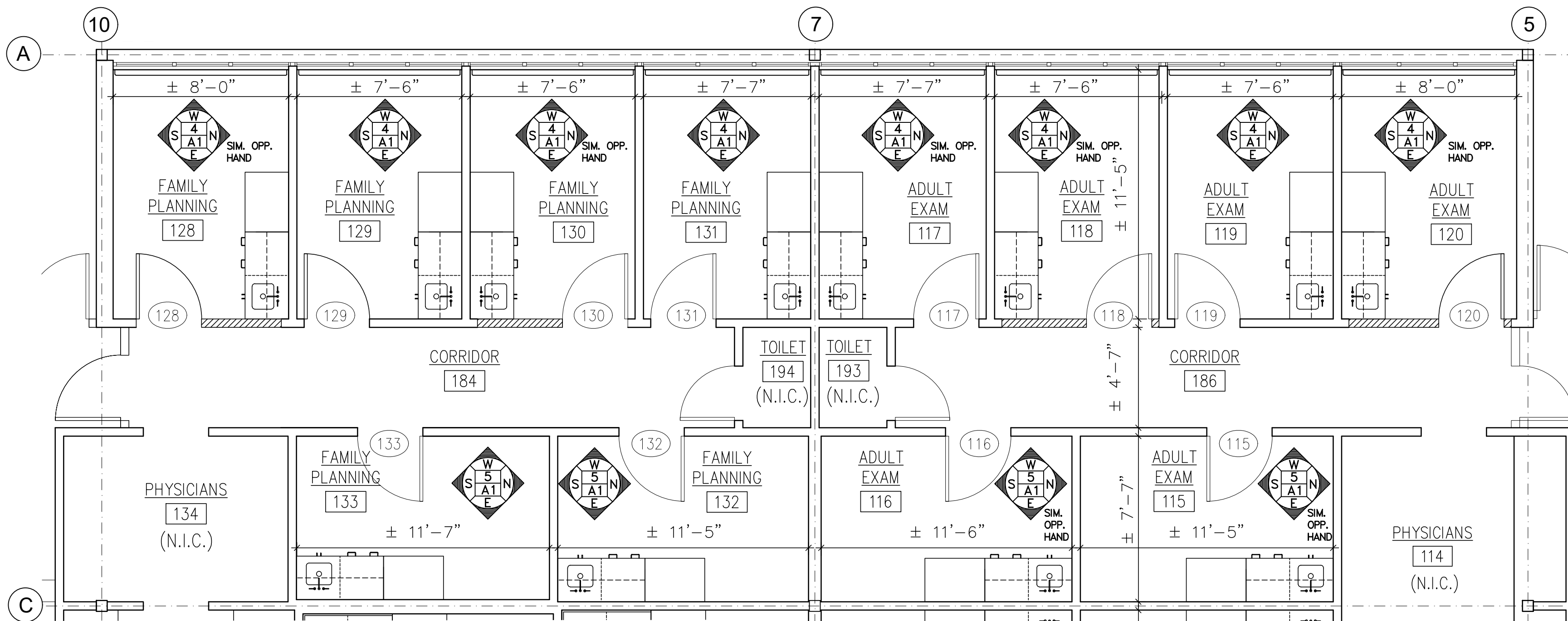

2 FLOOR PLAN
SCALE: 1/4" = 1'-0"

FINISH SCHEDULE			ROOM FINISH SCHEDULE				DOOR SCHEDULE						
IDEN	ITEM	DESCRIPTION	NO.	FLOOR FINSH	CEILING FINSH	FLIP DOOR/ NEW FRAME	TRCK/ CURTAIN	DOOR #	TYPE	MATL	SIZE	FRAME	HARDWARE
PT-1	WALL PAINT	"ALABASTER" TO MATCH EXISTING	107	VCT-1.2	PT-2	DF-1	CT-1	107	1	WOOD	36 x 84	NEW	PASSAGE
PT-2	CEILING PAINT	WHITE TO MATCH EXISTING	108	VCT-1.2	PT-2	DF-1	CT-1	108	1	WOOD	36 x 84	NEW	PASSAGE
PT-3	DOOR FRAME PAINT	BENJAMIN MOORE HC-169 "COVENTRY GRAY" SBI# GLOSS	109	VCT-1.2	PT-2	N/A	CT-1	109	1	WOOD	36 x 84	EXISTING	PASSAGE
DF-1	HOLLOW METAL DOOR FRAME	METAL DOOR FRAME TO MATCH PHASE 1	110	VCT-1.2	PT-2	N/A	CT-1	110	1	WOOD	36 x 84	NEW	PASSAGE
RR-1	RUB RAIL	PRO TEK SY SYSTEMS - CR 46 RGD VINYL "PEARL GRAY" 210	111	VCT-1.2	PT-2	N/A	CT-1	111	1	WOOD	36 x 84	EXISTING	PASSAGE
WB-1	VINYL WALL BASE	ROFFE NO TOE "STEEL BLUE" 177	112	VCT-1.2	PT-2	N/A	CT-1	112	1	WOOD	36 x 84	NEW	PASSAGE
CT-1	CEILING MOUNTED PRIVACY CURTAIN	60" WIDE HOSPITAL DISPOSABLE NON-MESH CURTAIN W/ CEILING TRACK, HOOKS ON ROLLERS, MOUNTING HARDWARE, END CAPS	113	VCT-1.2	PT-2	N/A	CT-1	113	1	WOOD	36 x 84	EXISTING	PASSAGE
DS-1	DOOR STOP	FLOOR MOUNT 2" DOME W/ RUBBER PAD, SATIN CHROME FINISH	114	VCT-1.2	PT-2	N/A	CT-1	114	1	WOOD	36 x 84	NEW	PASSAGE
CH-1	COAT HOOKS (2 PER DOOR)	TWO-FRONG, SCREW MOUNT, STAINLESS STEEL, SATIN FINISH	115	VCT-1.2	PT-2	N/A	CT-1	115	1	WOOD	36 x 84	EXISTING	PASSAGE
VCT-1	VINYL COMPOSITION TILE	ARMSTRONG "CLASSICS BLUE GRAY 51903"	116	VCT-1.2	PT-2	N/A	CT-1	116	1	WOOD	36 x 84	NEW	PASSAGE
VCT-2		ARMSTRONG "LEMON LICK 57509"	117	VCT-1.2	PT-2	N/A	CT-1	117	1	WOOD	36 x 84	NEW	PASSAGE

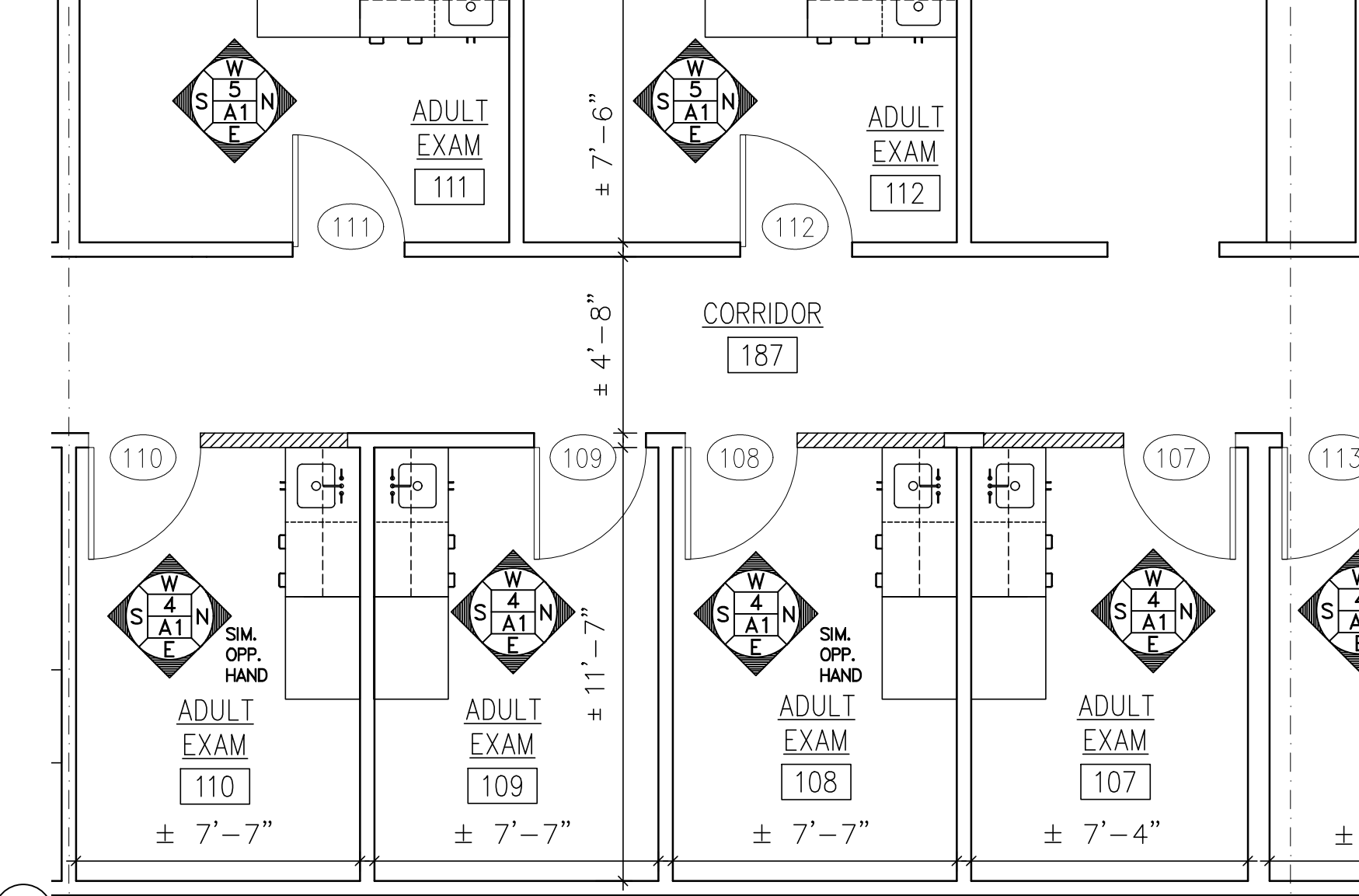

2 FLOOR PLAN
SCALE: 1/4" = 1'-0"

FLOOR FINISH NOTES:

1. EXISTING FLOOR TILE TO BE REMOVED BY OWNER.
2. FLASH PATCH SURFACE, REMOVE RAISED AREAS, SMOOTH AND PREPARE FLOOR FOR NEW V.C.T.
3. INSTALL TILE PATTERN AS SHOWN AND PROVIDE SMOOTH EDGE OF ROOM V.C.T. TO CORRIDOR V.C.T.

- VCT-1: "BLUE GRAY"
- ▨ VCT-2: "LEMON LICK"

3 FLOOR FINISH PLAN
1/8" = 1'-0"

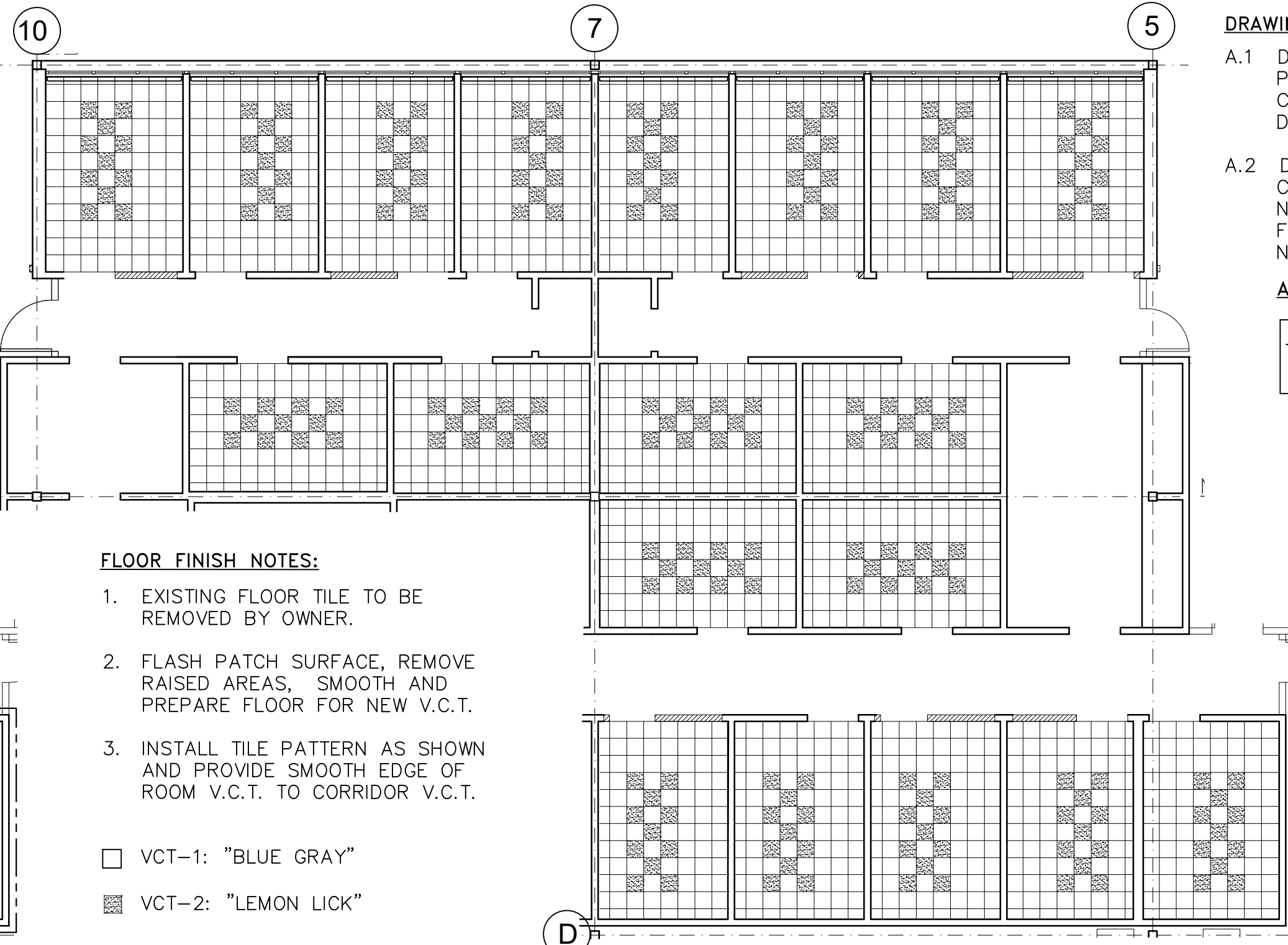

3 FLOOR FINISH PLAN
1/8" = 1'-0"

DRAWING LIST:

- A.1 DEMO, FLOOR, AND FINISH PLANS, ROOM ELEVATIONS, CASEWORK AND PARTITION DETAILS, NOTES & SCHEDULES
- A.2 DEMO & NEW REFLECTED CEILING PLANS, DEMO & NEW ELECTRICAL PLANS, FURNITURE PLAN, DETAILS, NOTES, AND SCHEDULES

AREA OF WORK:

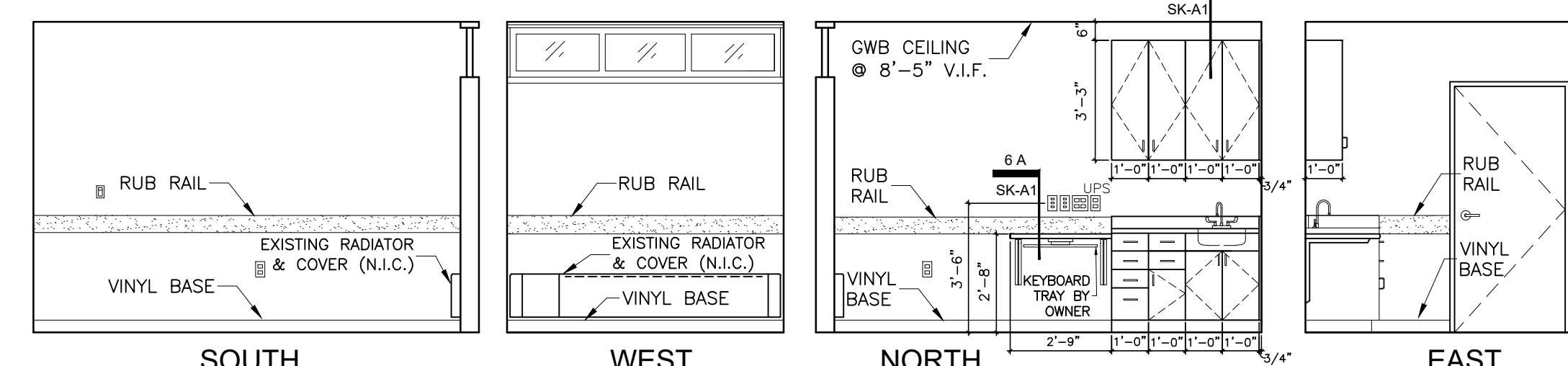
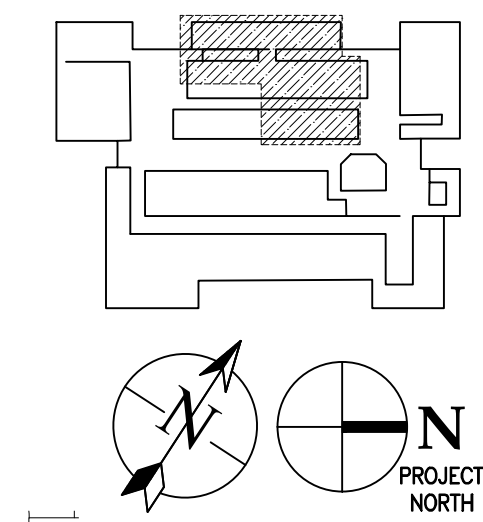

4 ROOM ELEVATIONS (RIGHT HAND): 107, 109, 119, 128, 129, 131
ROOM ELEVATIONS (SIM. OPP. HAND, LEFT HAND): 108, 110, 117, 118, 120, 130
SCALE: 1/4" = 1'-0"

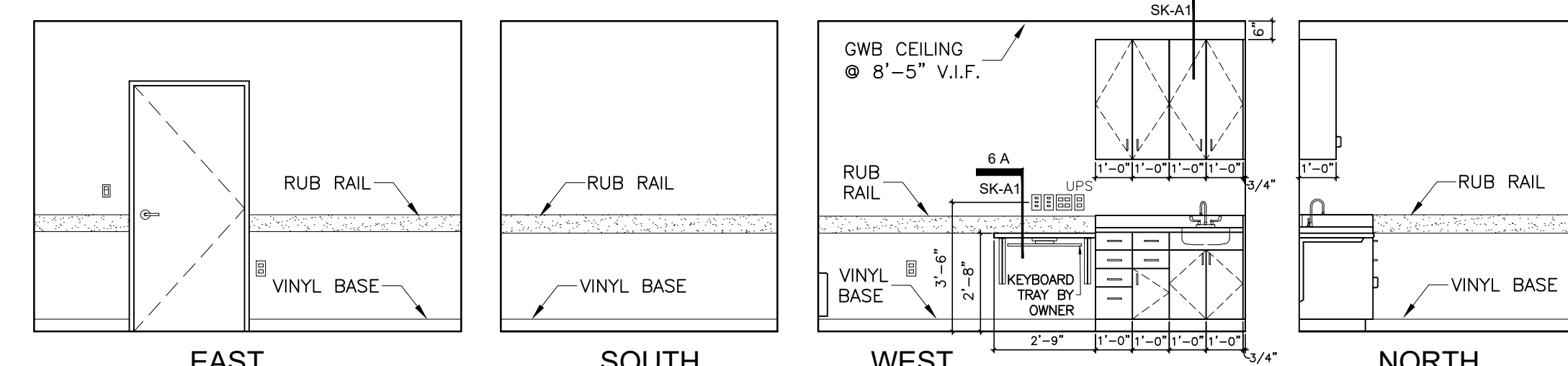

5 ROOM ELEVATIONS: 111, 112, 132, 133; SIM. OPP. HAND: 115, 116
SCALE: 1/4" = 1'-0"

CONSTRUCTION NOTES:

1. INSTALL: CASEWORK, WALL BASE, RUB RAIL, VINYL FLOOR TILE, GWB CEILING. SEE ROOM AND FINISH SCHEDULES.
2. SEE A.2, FOR MECHANICAL AND ELECTRICAL/DATA WORK.
3. LAMINATE: 1/4" GWB ON EXISTING WALLPAPER AND AREAS WHERE REMOVED. TAPE AND SPACKLE FOR NEW PAINT.
4. PAINT: WALLS, CEILING, DOOR FRAMES, SEE ROOM/FINISH SCHEDULES.
5. ALL EXAM ROOM DOORS: REMOVE, CLEAN, SAND, RE-FINISH, CLEAR COAT, AND RE-INSTALL WITH ALL HARDWARE AND ACCESSORIES.
6. RELOCATE ANY SPEAKERS OR CORRIDOR WALL-MOUNTED FIXTURES DUE TO DEMOLITION.
7. PLUMBING: CONNECT SINKS TO EXISTING SUPPLY, VENT, DRAIN LINES OR MOVE LINES AS REQUIRED.

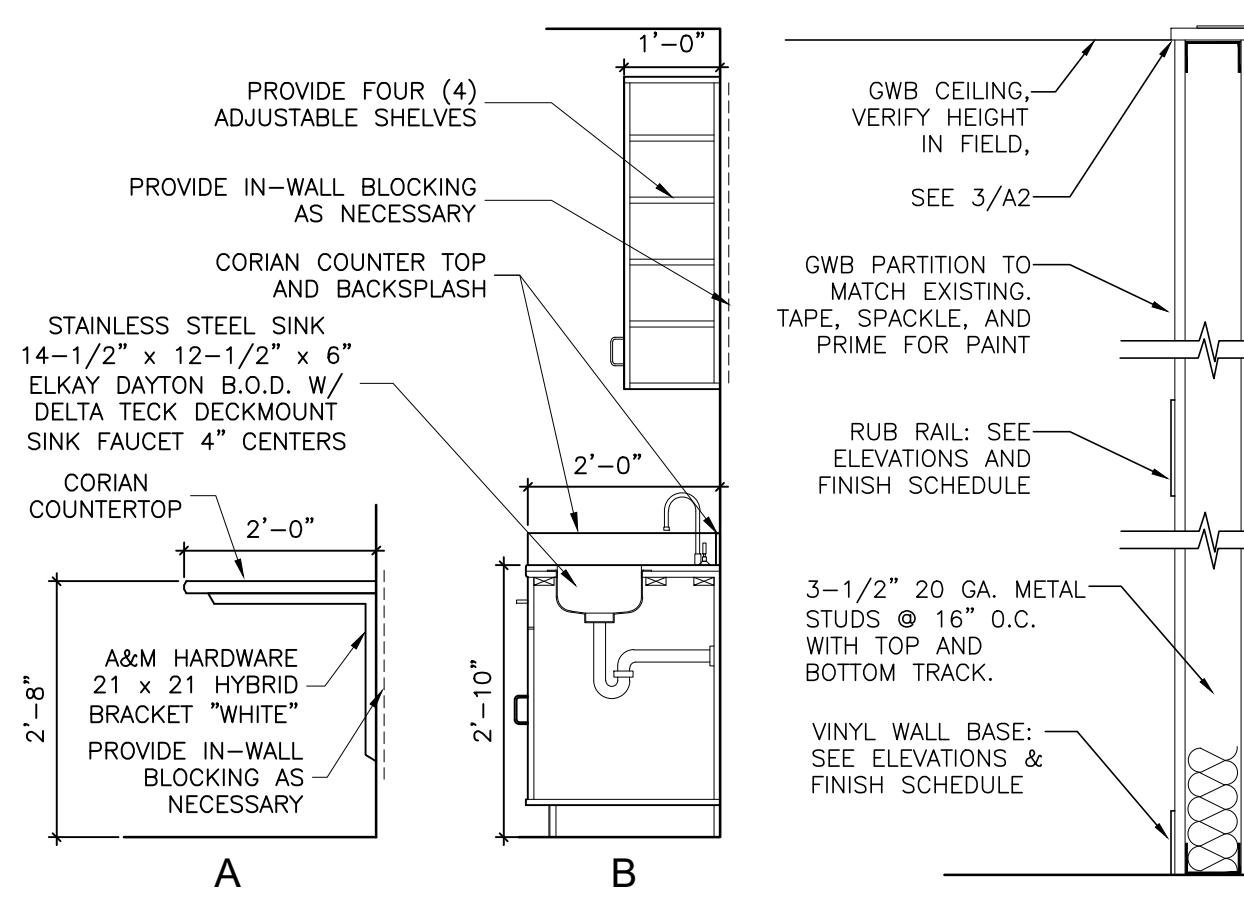

6 CASEWORK SECTIONS
SCALE: 1/2" = 1'-0"

7 PARTITION DETAILS
SCALE: 1" = 1'-0"

REVISIONS

ISSUE	DATE	REVISIONS



PROJECT COORDINATOR:
MICHAEL MARTELLA

SEAL:

ARCHITECT:

CONSULTANT:

CITY OF PHILADELPHIA
DEPARTMENT OF PUBLIC PROPERTY
CITY HALL - 7TH FLOOR
1400 JOHN F. KENNEDY BLVD.
PHILADELPHIA PENNSYLVANIA

PROJECT TITLE:
HEALTH CARE CENTER NO. 10
PHASE 3 INTERIOR IMPROVEMENTS
EXAM ROOMS 107-120 & 128-132

DRAWING TITLE:
DEMO, FLOOR, FINISH PLANS,
ROOM ELEVATIONS,
CASEWORK DETAILS,
NOTES, AND SCHEDULES

PROJECT NO:
14-18-4745-01

DATE:
10/18/2019

DRAWN BY:
MM

CHECKED BY:
MD, JL

DRAWING NO:
SK-A1

FILE PATH: /

NOTE: ALL DIMENSIONS AND CONDITIONS SHALL BE VERIFIED BY THE CONTRACTOR AT THE SITE BEFORE PROCEEDING WITH THE WORK

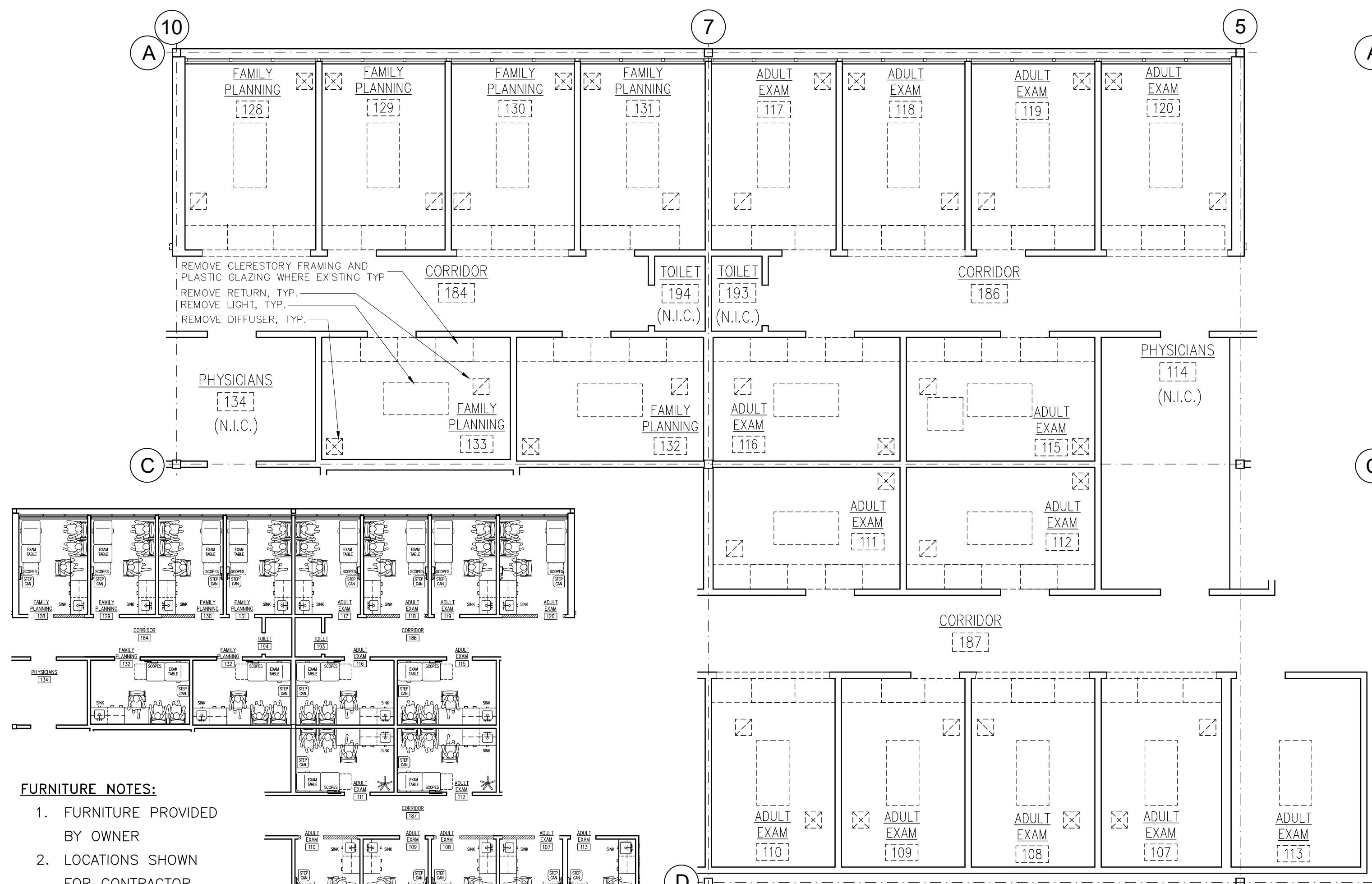

2 REFLECTIVE CEILING PLAN - SELECTIVE DEMO
SCALE: 3/16" = 1'-0"

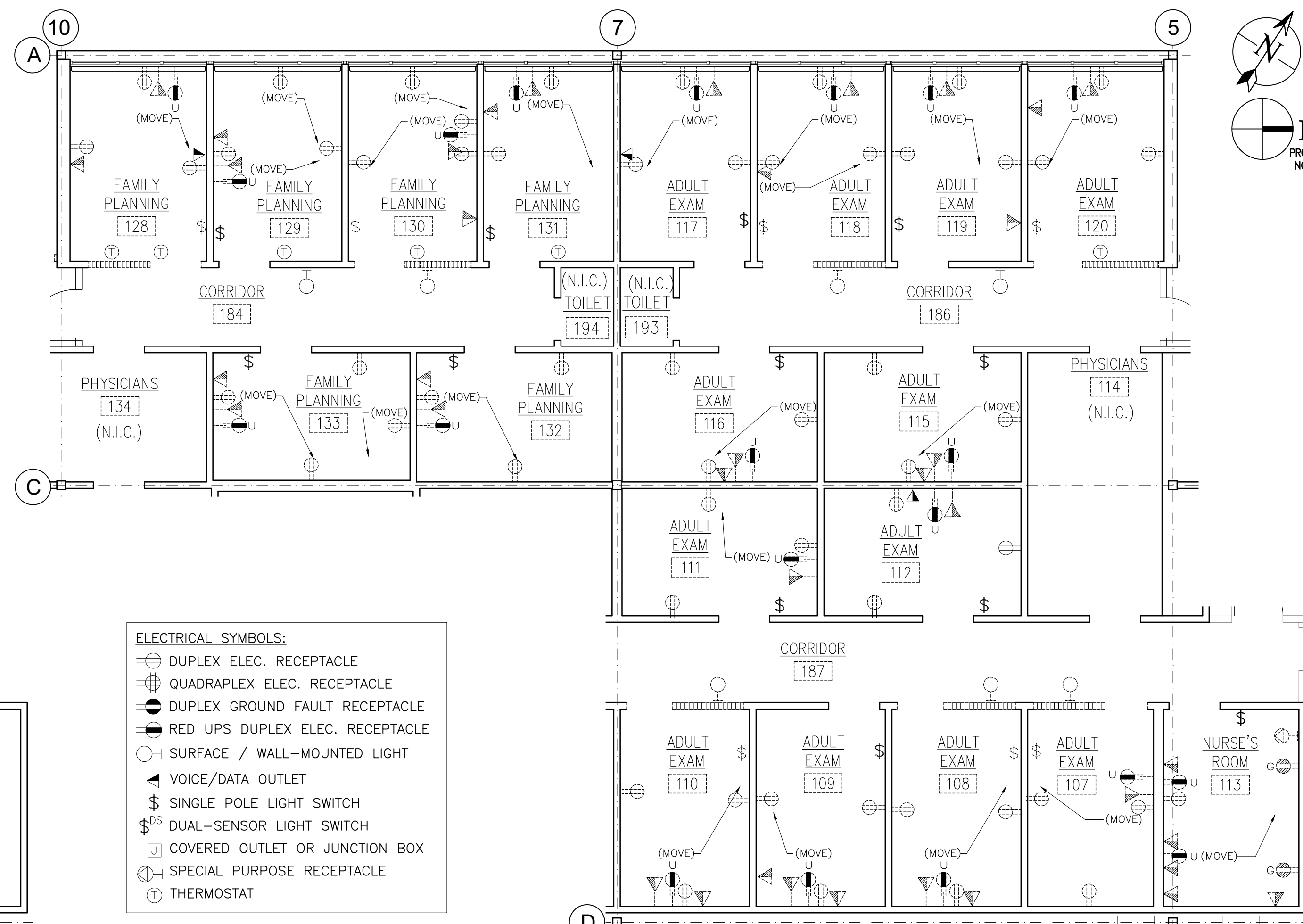

5 ELECTRICAL PLAN - SELECTIVE DEMO
SCALE: 3/16" = 1'-0"

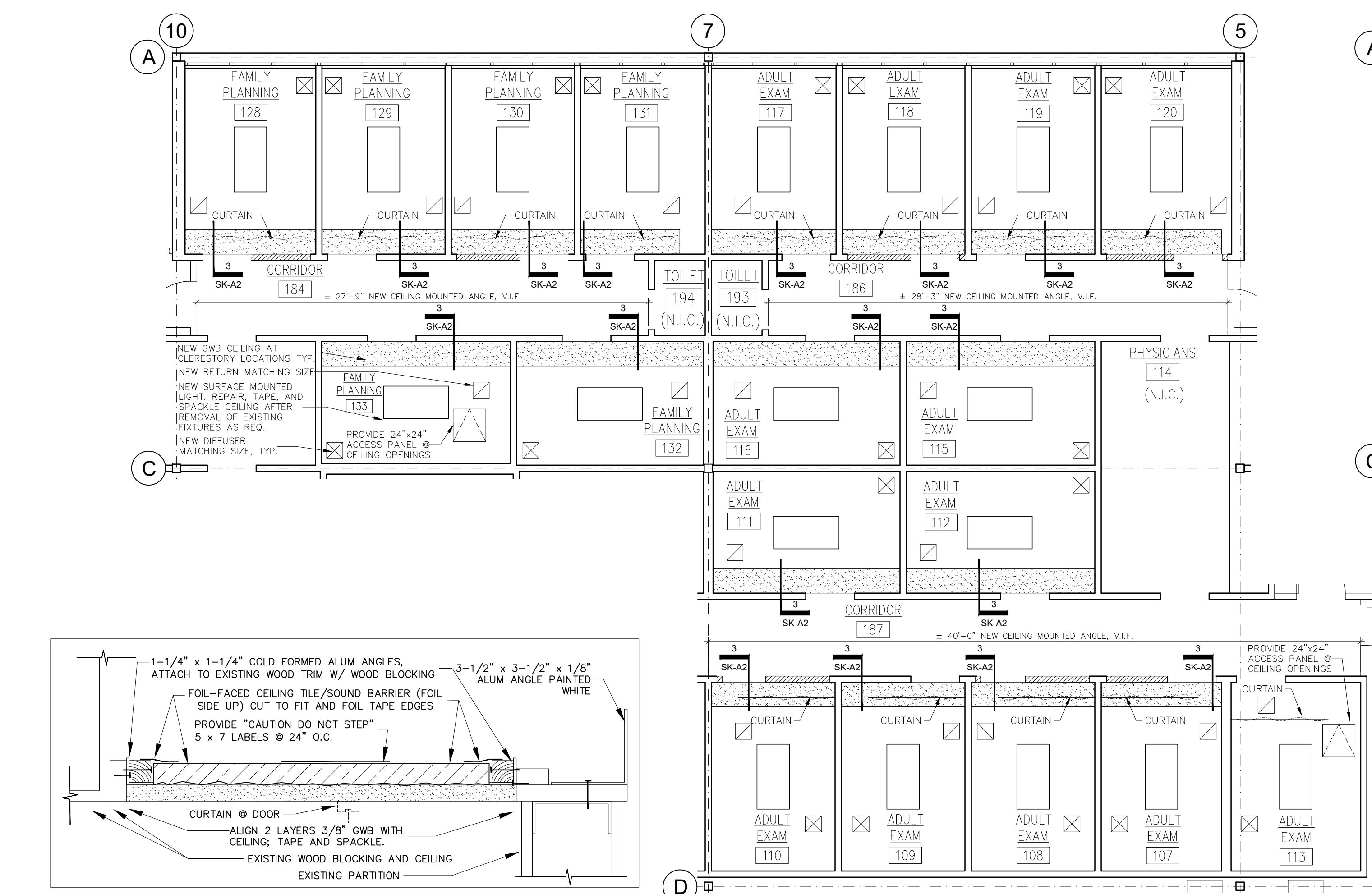

4 REFLECTIVE CEILING PLAN - NEW WORK
SCALE: 3/16" = 1'-0"

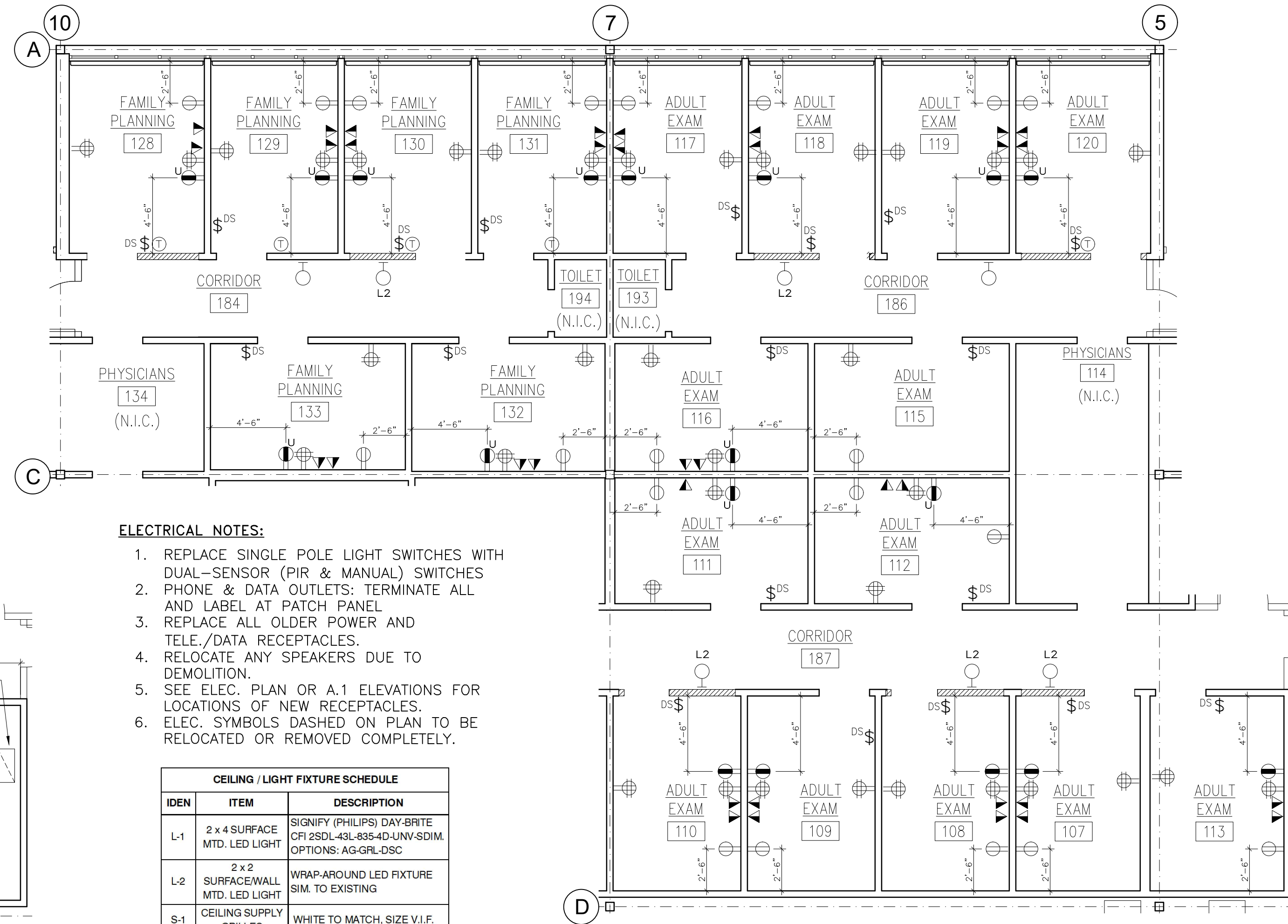

6 ELECTRICAL PLAN - NEW WORK
SCALE: 3/16" = 1'-0"

IDEN	ITEM	DESCRIPTION
L-1	2 x 4 SURFACE MTD. LED LIGHT	SIGNIFY (PHILIPS) DAY-BRITE CFI 2SDL-43L-835-4D-UNV-SDIM. OPTIONS: AG-GRL-DSC
L-2	2 x 2 SURFACE/WALL MTD. LED LIGHT	WRAP-AROUND LED FIXTURE SIM. TO EXISTING
S-1	CEILING SUPPLY GRILLES	WHITE TO MATCH, SIZE V.I.F.
R-1	CEILING RETURN GRILLES	WHITE TO MATCH, SIZE V.I.F.

REVISIONS		
ISSUE	DATE	REVISIONS

PROJECT COORDINATOR: MICHAEL MARTELLA

SEAL:

ARCHITECT:

CONSULTANT:

CITY OF PHILADELPHIA
DEPARTMENT OF PUBLIC PROPERTY
CITY HALL - 7TH FLOOR
1400 JOHN F. KENNEDY BLVD.
PHILADELPHIA PENNSYLVANIA

PROJECT TITLE: HEALTH CARE CENTER NO. 10
PHASE 3 INTERIOR IMPROVEMENTS
EXAM ROOMS 107-120 & 128-132

DRAWING TITLE: DEMO AND NEW REFLECTED CEILING AND ELECTRICAL PLANS, DETAILS, NOTES, SCHEDULE

PROJECT NO: 14-18-4745-01 **DRAWING NO:** SK-A2

DATE: 10/18/2019

DRAWN BY: MM

CHECKED BY: MD, JL **FILE PATH:**

NOTE: ALL DIMENSIONS AND CONDITIONS SHALL BE VERIFIED BY THE CONTRACTOR AT THE SITE BEFORE PROCEEDING WITH THE WORK