

REVISIONS

ISSUE	DATE	REVISIONS
1	9/4/15	85% DPP REVIEW
2	12/10/18	ISSUE FOR CONSTRUCTION

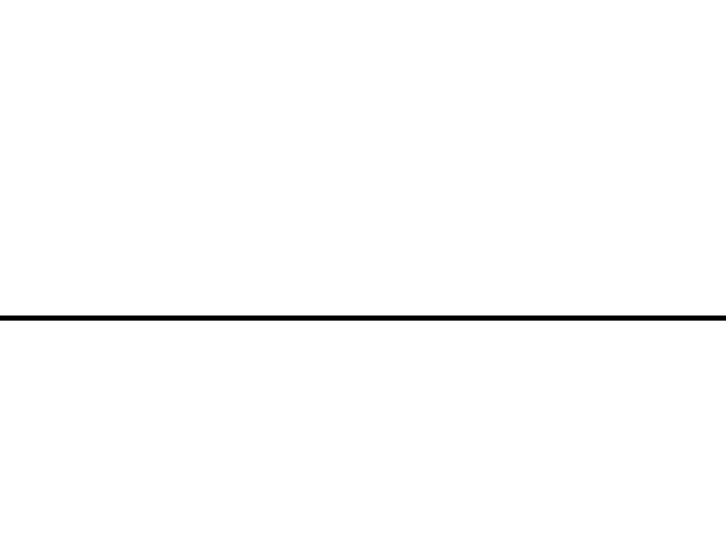

PENNSYLVANIA ONE CALL SYSTEM, INC.
 925 South Star Road
 West Mifflin, Pennsylvania
 15122-1078

BEFORE YOU DIG ANYWHERE IN PENNSYLVANIA CALL 1-800-242-1776
 NON-MEMBERS MUST BE CONTACTED DIRECTLY
 PA LAW REQUIRES THREE WORKING DAYS NOTICE TO UTILITIES BEFORE YOU EXCAVATE, DRILL, BLAST OR BURN!

PA ONE CALL NUMBER (FOR DESIGN ONLY): 20183382907

BPP PROJECT COORDINATOR: FRANCESCO CERRAI, RLA



DESIGN CONSULTANT:
GILMORE & ASSOCIATES, INC.
 DESIGN, ENGINEERING, LANDSCAPE ARCHITECTURE & TECHNICAL CONSULTING
 ONE PENN CENTER AT SUBURBAN STATION
 1617 JFK BOULEVARD, SUITE 820
 PHILADELPHIA, PA 19103
 PHONE: (800) 344-9567

CITY OF PHILADELPHIA
 DEPARTMENT OF PUBLIC PROPERTY
 1515 ARCH STREET
 11TH FLOOR, ONE PARKWAY BUILDING
 PHILADELPHIA, PENNSYLVANIA

DPP PROJECT NUMBER: 16-14-4230-01
 PROJECT TITLE: IMPROVEMENTS TO GIFFORD PLAYGROUND
 575 TOMLINSON ROAD, PHILA. PA

DRAWING TITLE: SPRAY AREA ENLARGEMENT PLAN

BPP PROJECT NO.: 16-14-4230-01
 CONSULTANT PROJECT NO.: 2014-02041-07
 DATE: 12/10/2018
 SCALE: AS NOTED
 DRAWN BY: MDS
 CHECKED BY: KMS

DRAWING NO.: **L-2.2**
 NOTE: ALL DIMENSIONS AND CONDITIONS SHALL BE VERIFIED BY THE CONTRACTOR AT THE SITE BEFORE PROCEEDING WITH THE WORK.

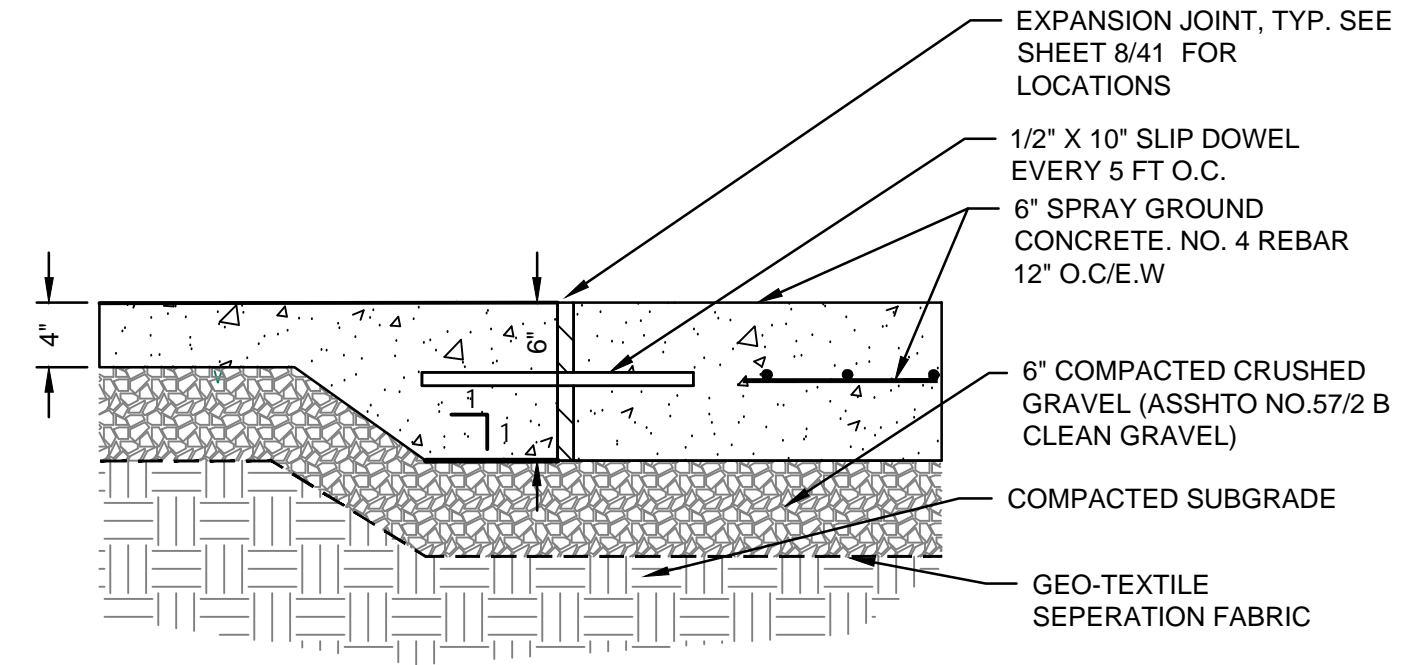

3 4" TO 6" CONCRETE DETAIL
 SCALE: NTS

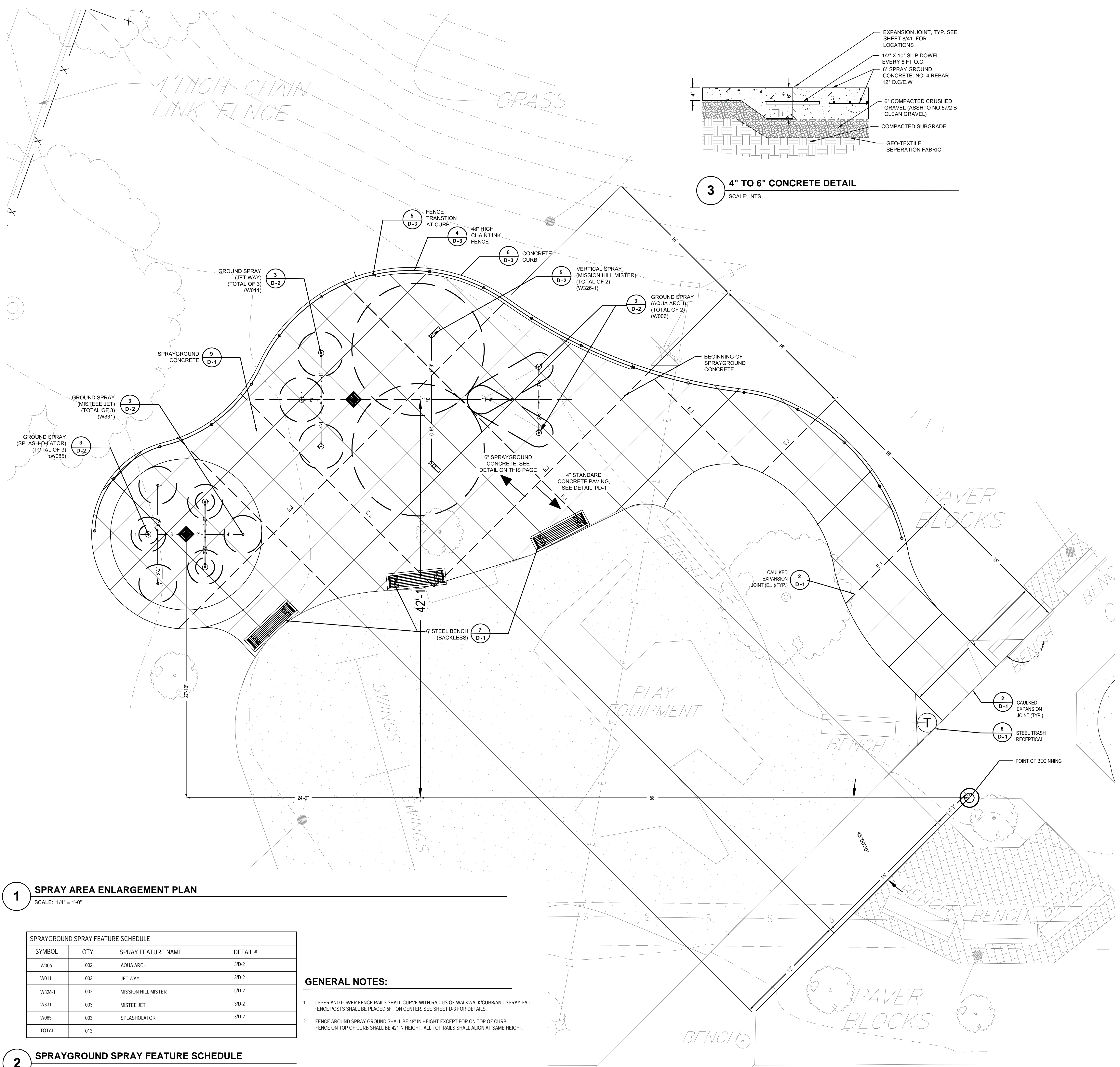

1 SPRAY AREA ENLARGEMENT PLAN
 SCALE: 1/4" = 1'-0"

SPRAYGROUND SPRAY FEATURE SCHEDULE			
SYMBOL	QTY.	SPRAY FEATURE NAME	DETAIL #
W006	002	AQUA ARCH	3D-2
W011	003	JET WAY	3D-2
W326-1	002	MISSION HILL MISTER	5D-2
W331	003	MISTEE JET	3D-2
W085	003	SPLASHOLATOR	3D-2
TOTAL	013		

- GENERAL NOTES:**
- UPPER AND LOWER FENCE RAILS SHALL CURVE WITH RADIUS OF WALKWALK/CURB/AND SPRAY PAD. FENCE POSTS SHALL BE PLACED 6FT ON CENTER. SEE SHEET D-3 FOR DETAILS.
 - FENCE AROUND SPRAY GROUND SHALL BE 48" IN HEIGHT EXCEPT FOR ON TOP OF CURB. FENCE ON TOP OF CURB SHALL BE 42" IN HEIGHT. ALL TOP RAILS SHALL ALIGN AT SAME HEIGHT.

2 SPRAYGROUND SPRAY FEATURE SCHEDULE
 SCALE: NTS

